

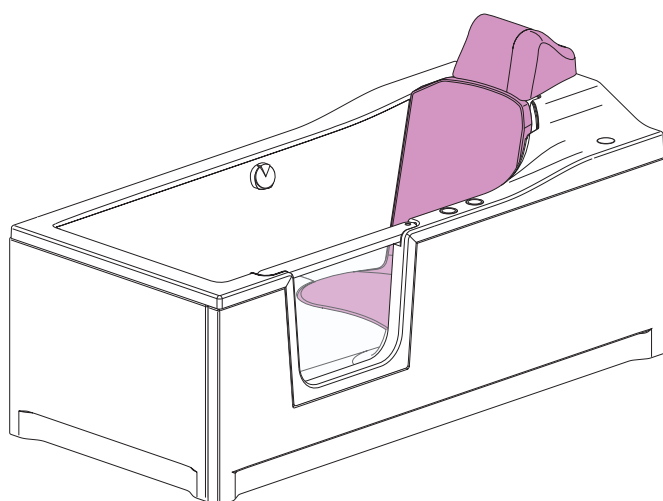

SANIKU

## BATHTUBS & WHIRLPOOLS

### BATHTUB DIVINA



GB INSTALLATION INSTRUCTIONS

## IMPORTANT INSTRUCTIONS!



Before installation, please check to make sure the product has not been damaged during transportation. No responsibility will be accepted for damage to products after installation.



Choose the silicone to suit the building materials used (especially if using natural stones such as granite or marble).



This product is not intended for use by people (including children) with limited physical, sensory or mental abilities or a lack of experience and/or knowledge unless they are supervised by a person with responsibility for their safety or have been instructed in how to use the product. Children must be supervised to ensure that they do not play with the product.



Please keep these instructions in a safe place. Please contact customer services if any spare or wear parts are required (see table).

[Name of wear part: \*\*\*].

## CLEANING INSTRUCTIONS!



Please use a sponge or soft cloth for daily cleaning and care. Use gentle, environmentally-friendly household cleaners. The smooth, non-porous surface of the bath is easy to clean. Under no circumstances are sharp objects, steel wool, chemicals or sand-based scouring products to be used, as they will damage the surface and invalidate the guarantee. You can easily remove slight limescale deposits below the waterline or tap with a little vinegar. Do not use limescale remover or kettle cleaners under any circumstances, as the chemical additives in them may permanently discolour the acrylic surface of your bath. Do not allow any organic solvents to come into contact with your bath, as they may cause irreversible damage.

## SYMBOLS



May disturb the function.



May be harmful to your health.



Cleaning and care instructions to maintain the high quality and function.

## CONTENTS

### INFORMATION

IMPORTANT INFORMATION ..... PAGE 2

CARE INSTRUCTIONS ..... PAGE 2

### TECHNICAL DATA SHEET

DIMENSIONS ..... PAGE 3

### SANIKU DUO BATH WITH APRON

EXPLODED DRAWING ..... PAGE 4

ORDER FOR SPARE PARTS ..... PAGE 5

CUSTOMER SERVICES ..... PAGE 5

INSTALLATION ..... PAGE 6-12

### MAINTENANCE

SEAT REMOVAL / INSTALLATION ..... PAGE 12

WASTE WATER FILTER REPLACEMENT ..... PAGE 13

WHAT TO DO IF... ..... PAGE 14

PROBLEM, POSSIBLE CAUSE, SOLUTION ..... PAGE 15

### CONTACT

SANIKU ADDRESS ..... PAGE 16

# TECHNICAL DATA SHEET

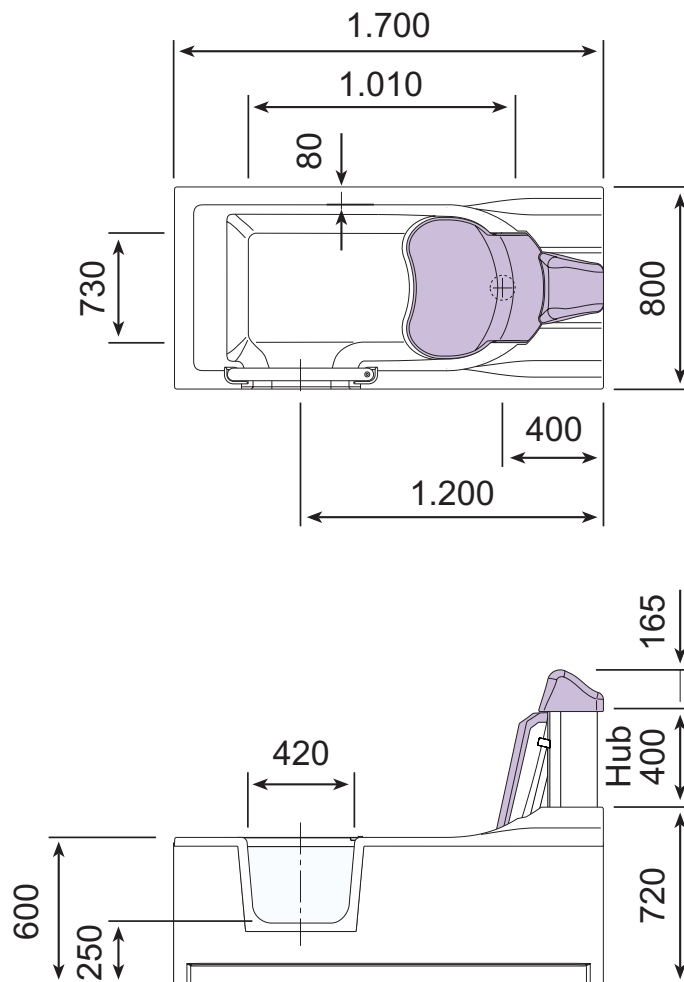





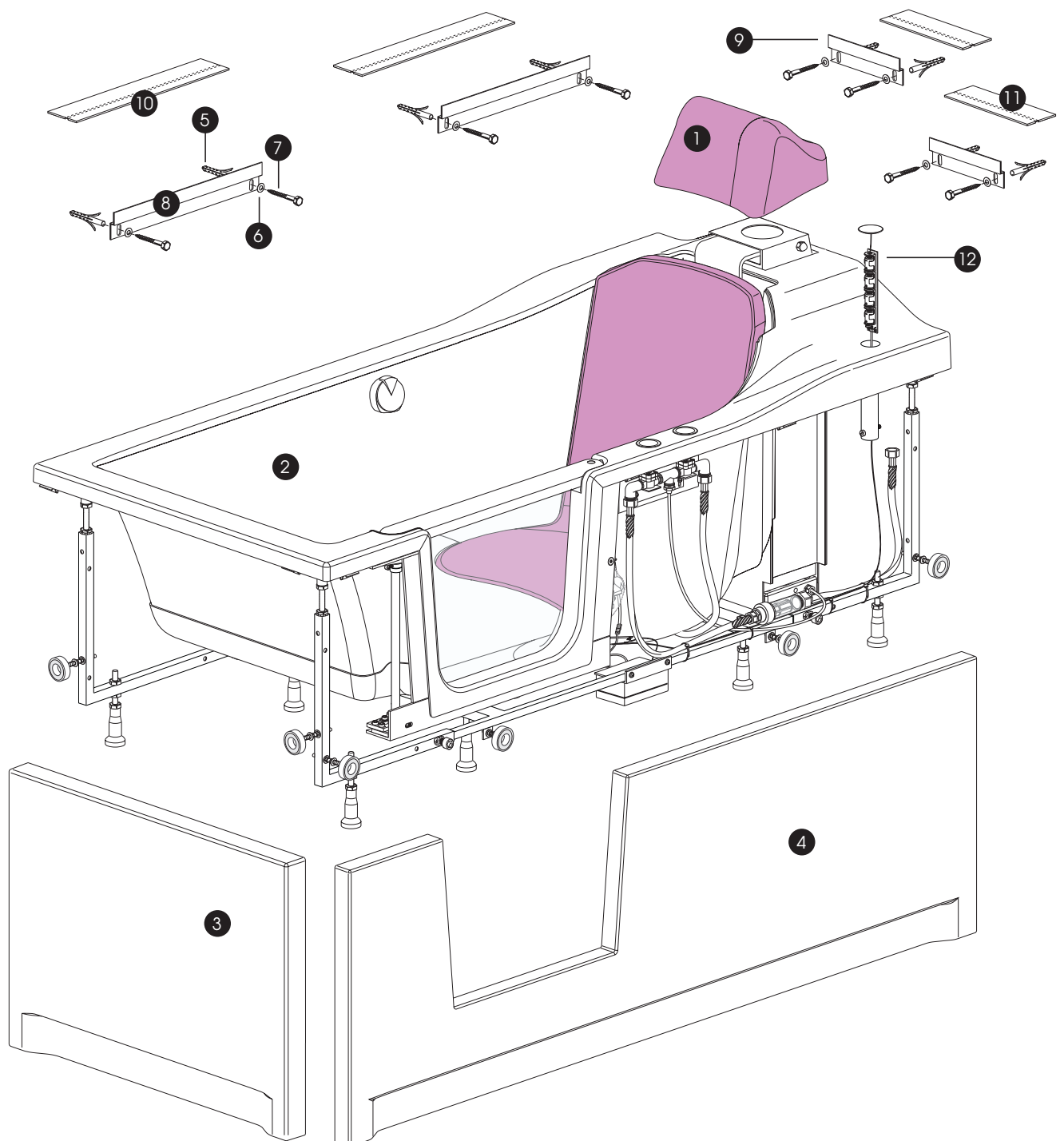
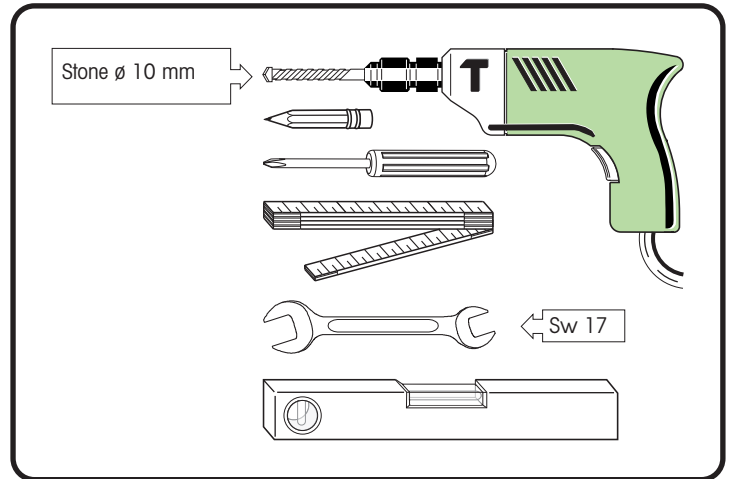
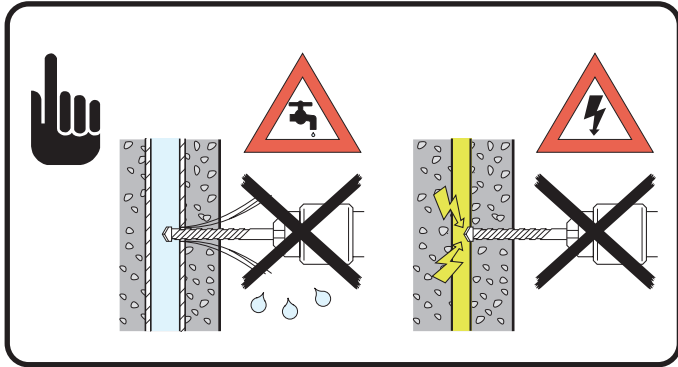

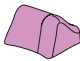
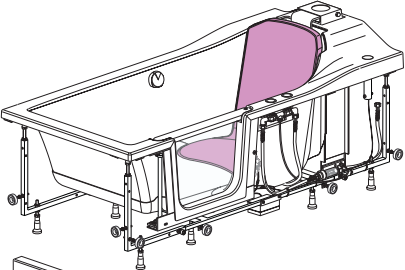
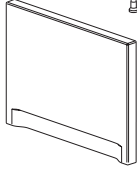
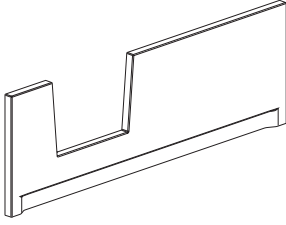

All dimensions in mm

# EXPLOSION DESIGN WITH APRON

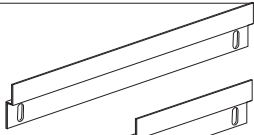

# Order for spare parts: **BATHTUBS & WHIRLPOOLS** DIVINA BATH WITH APRON

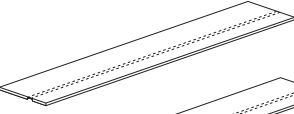
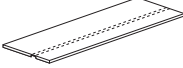
Please keep these instructions in a safe place. Please contact customer services if any spare or wear parts are required (see table). **[Name of wear part: \*\*\*]**.

No.	Designation	Article No.	Pieces
1.		Padded neckrest	1x
2.		Bath	1x
3.		Apron	1x
4.		Apron	1x
5.	 Dowel ø 10 mm	4 - 0000610	8x
6.	 6,4 DIN125	4 - 0000422	8x
7.	 6x60 DIN571	4 - 0000122	8x
8.	 Wall track	19 - 0000401	2x
9.		19 - 0000401	2x
10.	 Adhesive tape	14 - 0000221	2x
11.		14 - 0000221	2x
12.	 Battery type CR2	21 - 1230212	4x

SANIKU Customer Services

Fax: 0 26 39 / 96 16 - 22

Tel.: 0 26 39 / 96 16 - 0

Monday - Friday 8.00 - 18.00 hrs

Email: [info@saniku.de](mailto:info@saniku.de)

Internet: [www.saniku.de](http://www.saniku.de)

# INSTALLATION WITH APRON

1.

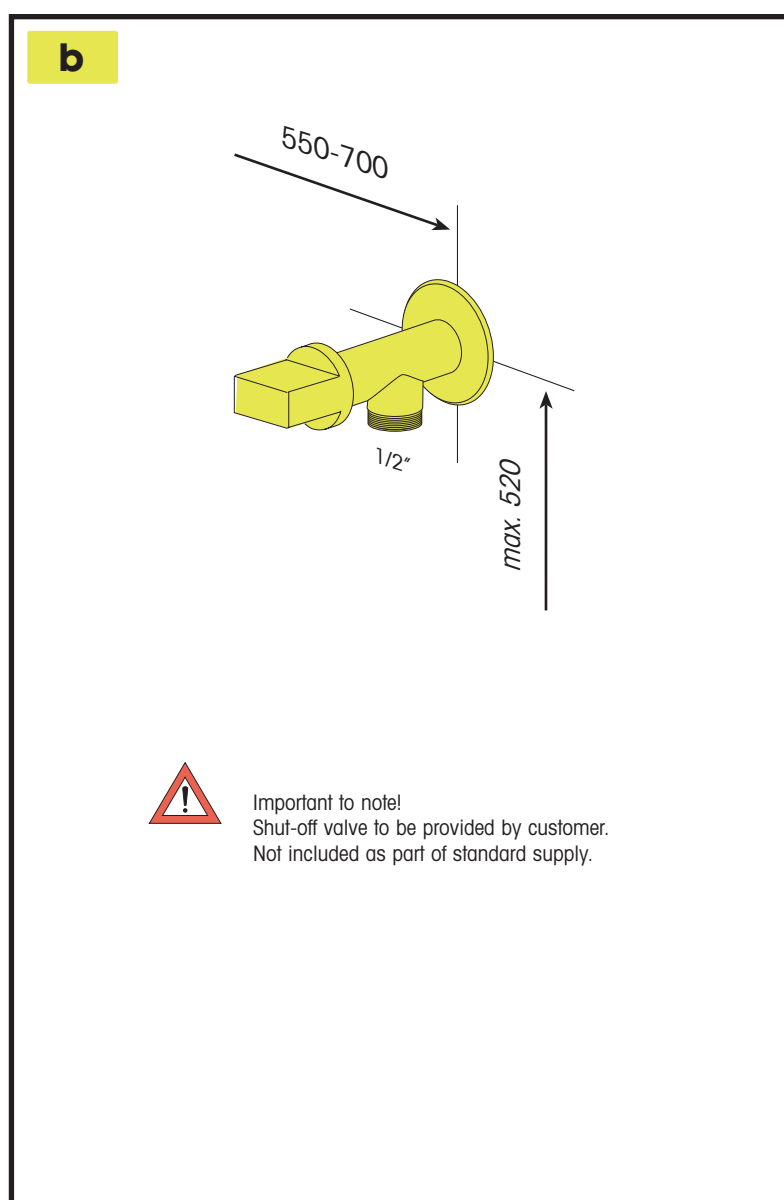
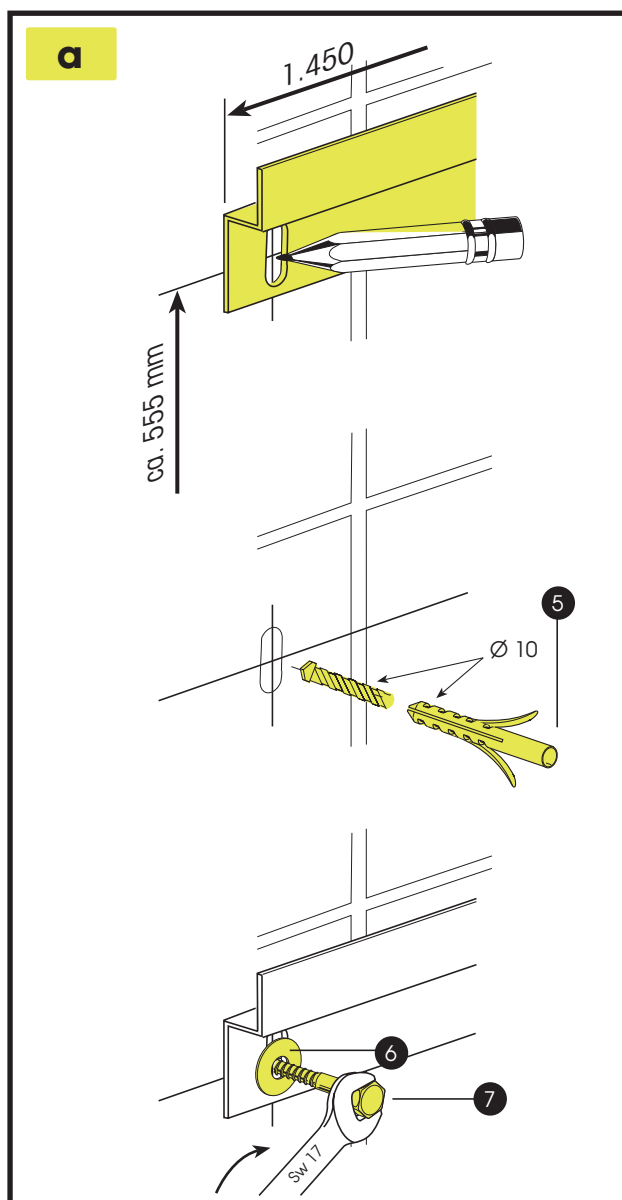
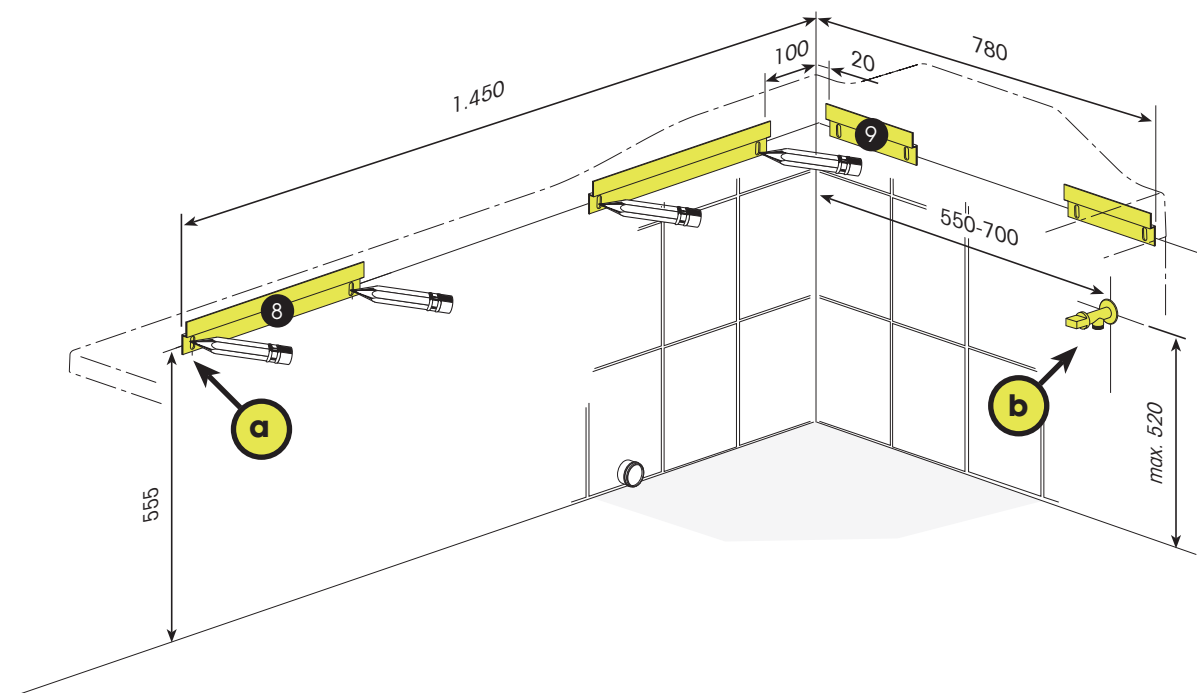

## 2.

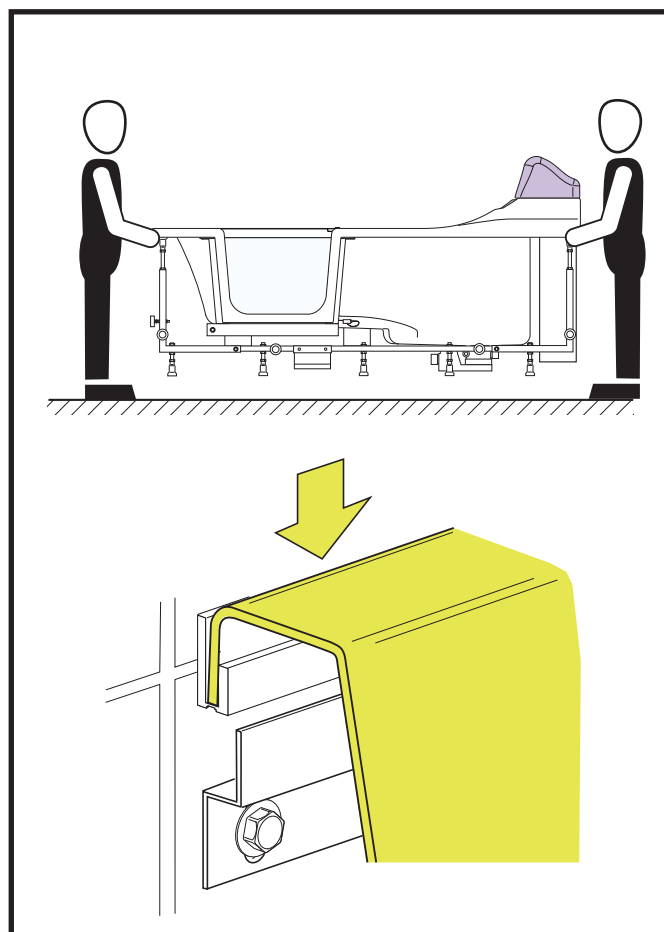
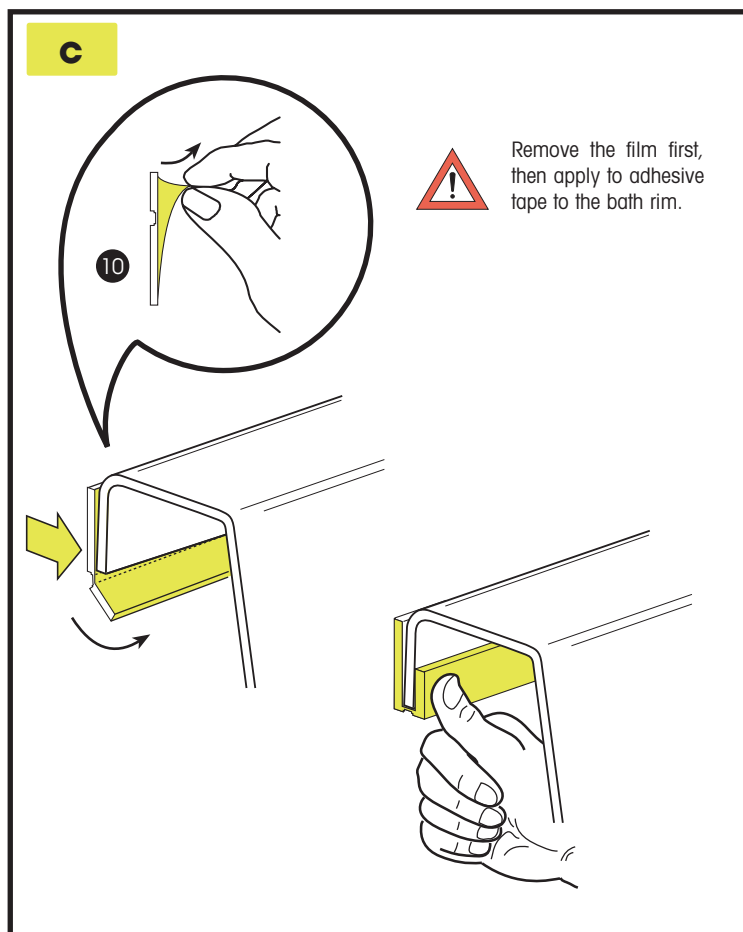
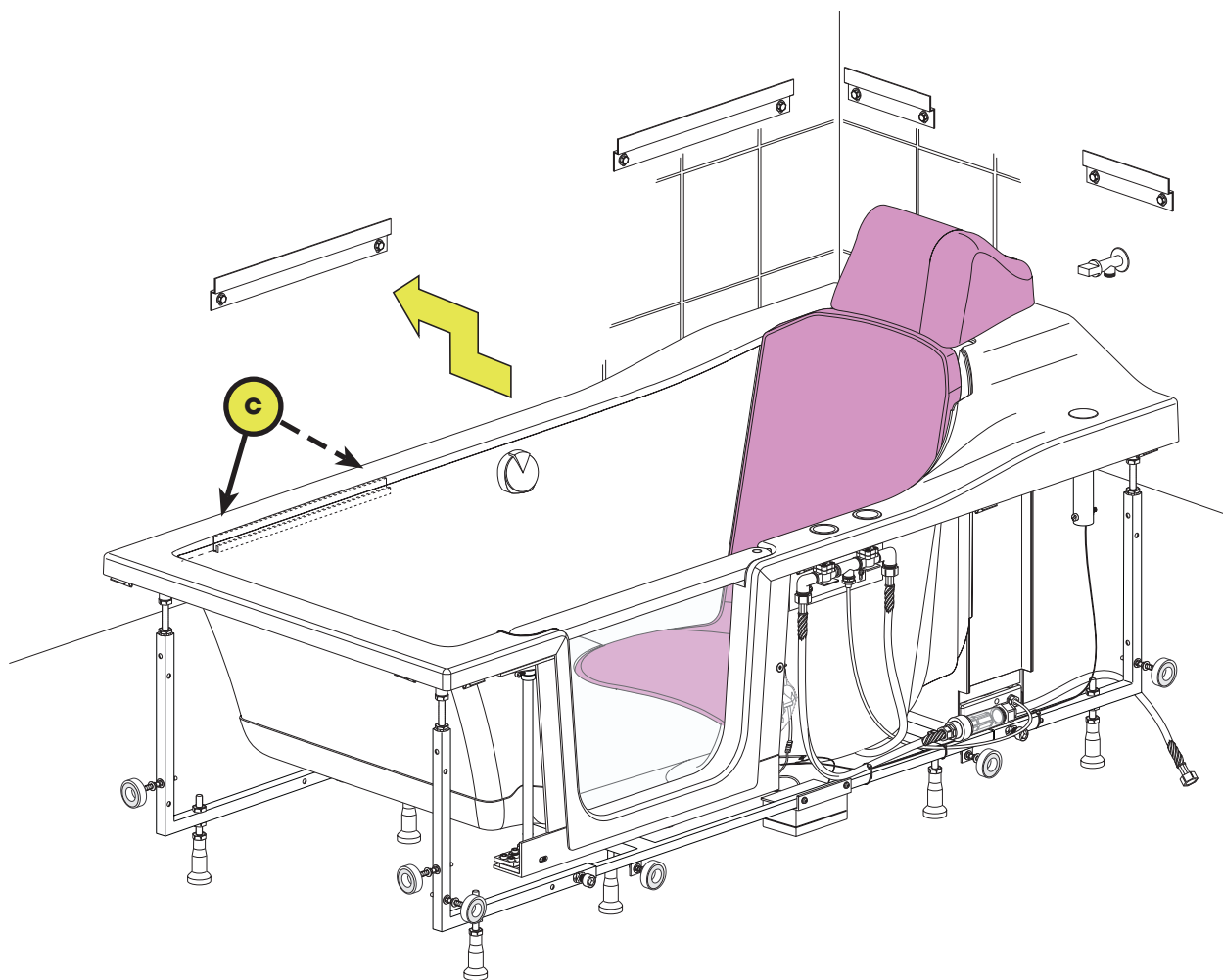

3.

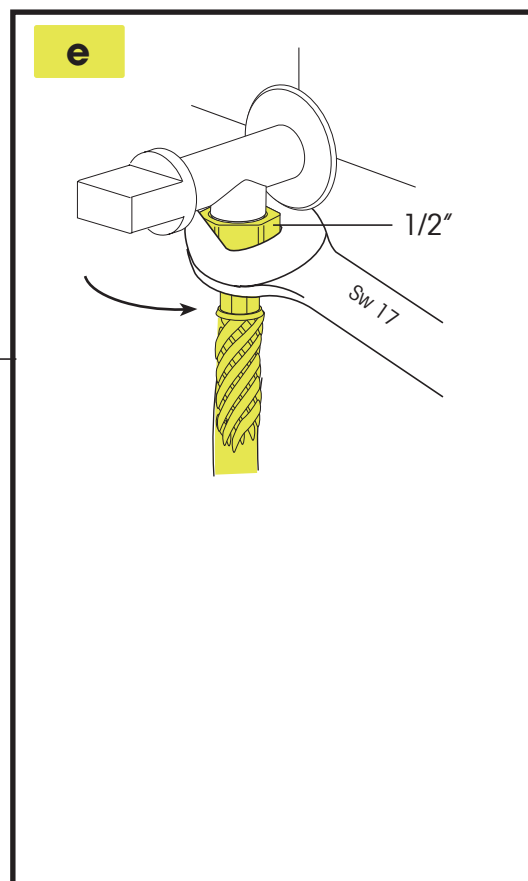
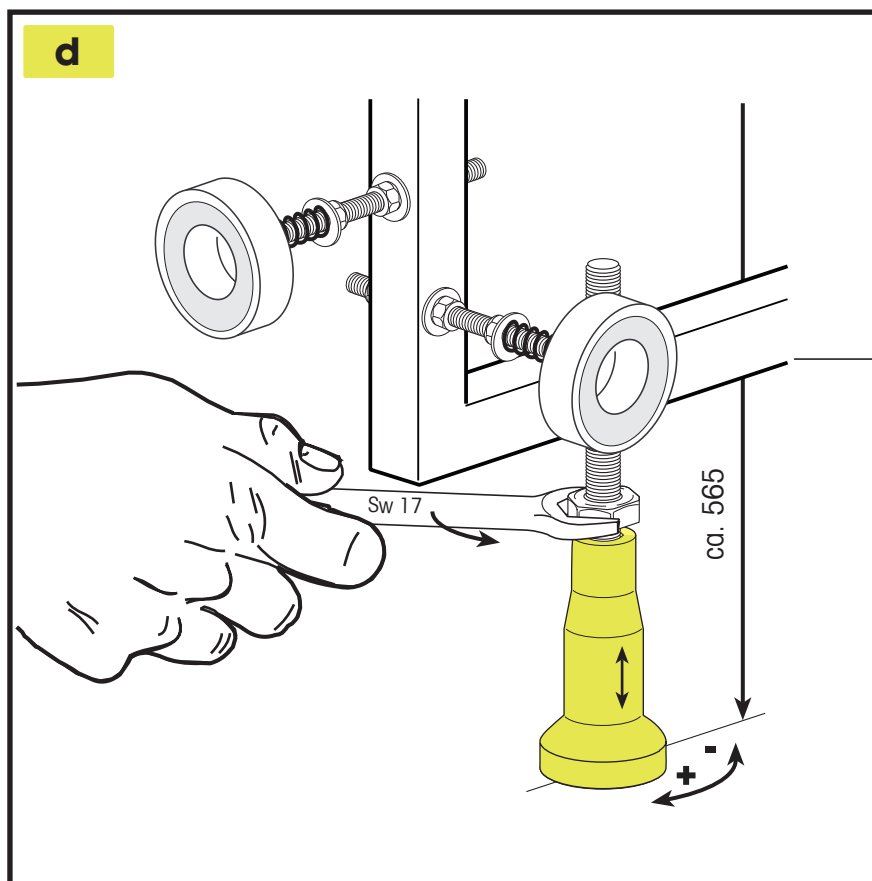
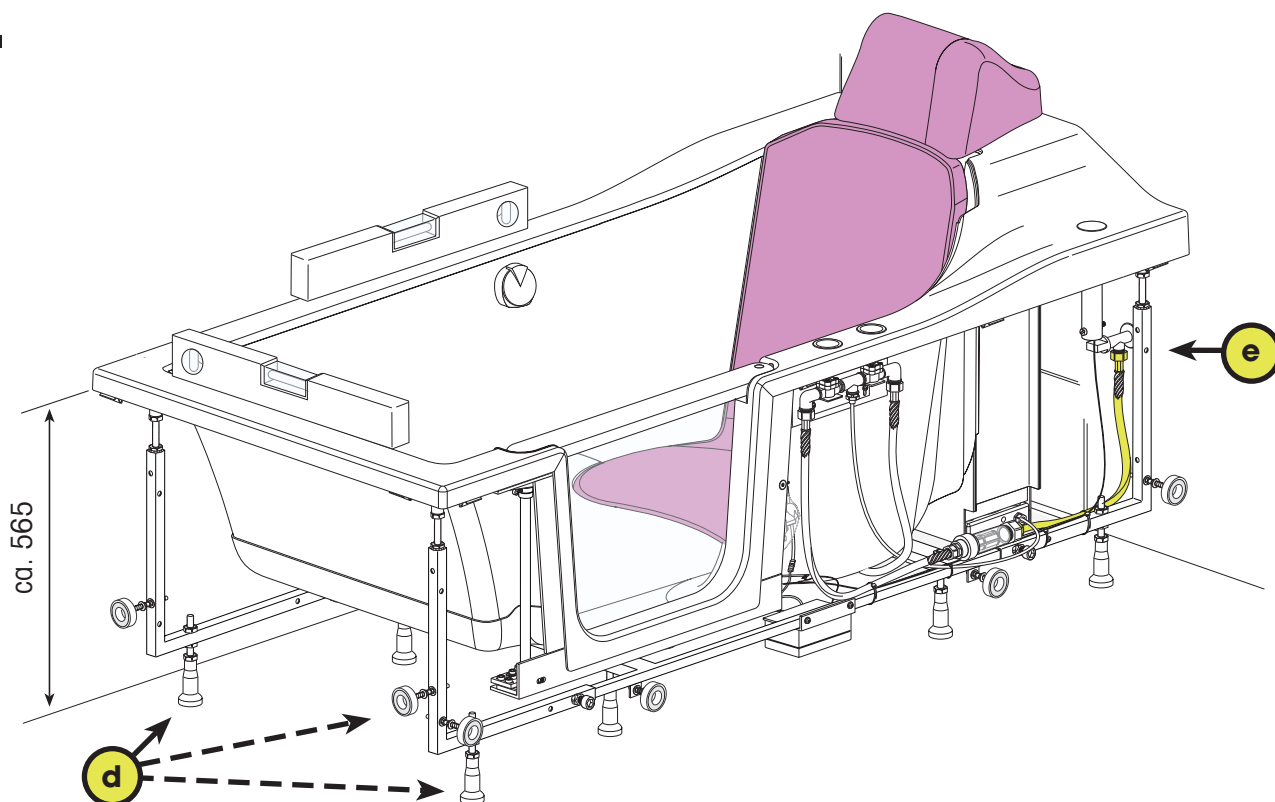



## 4.

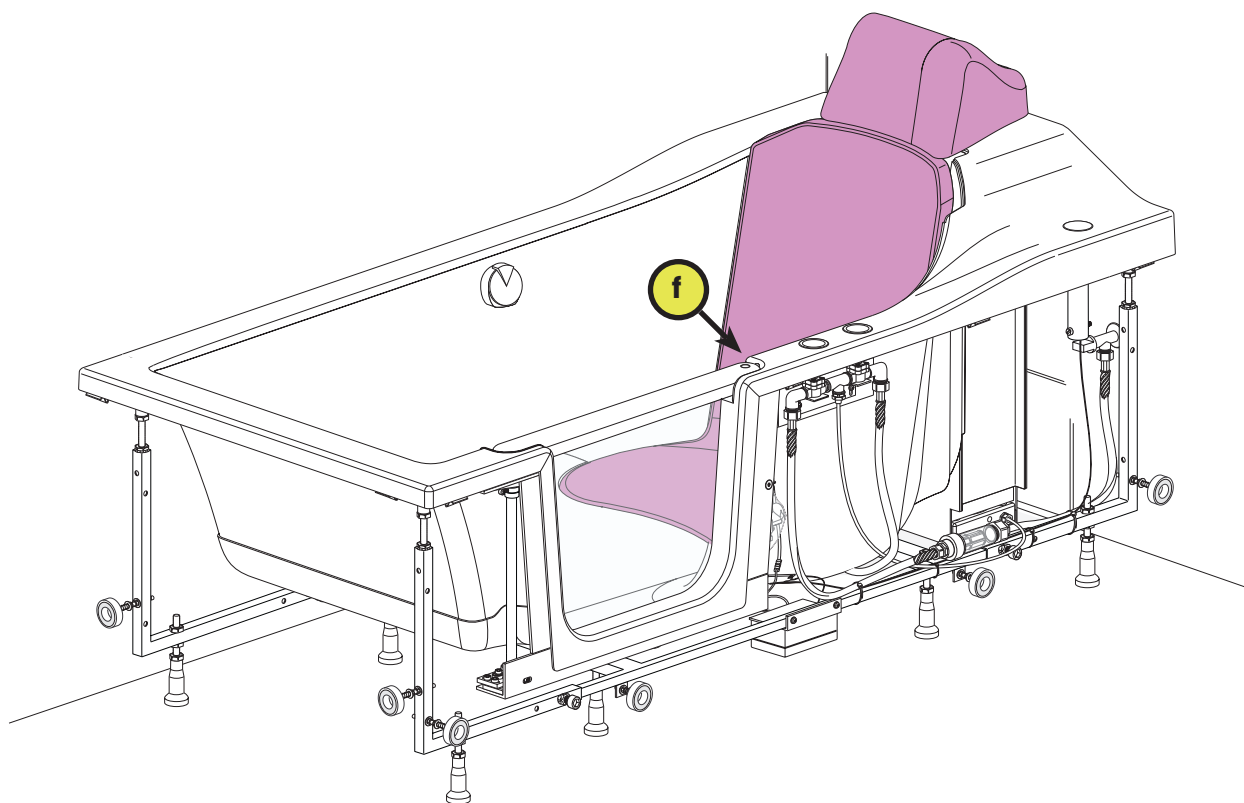

**f**

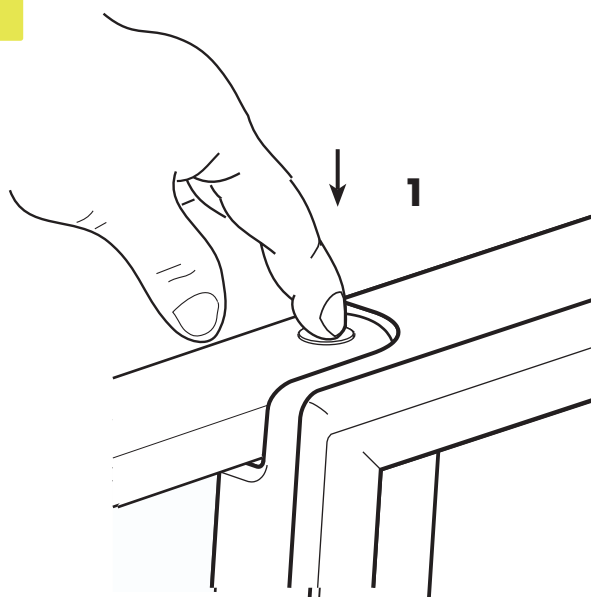

**2**

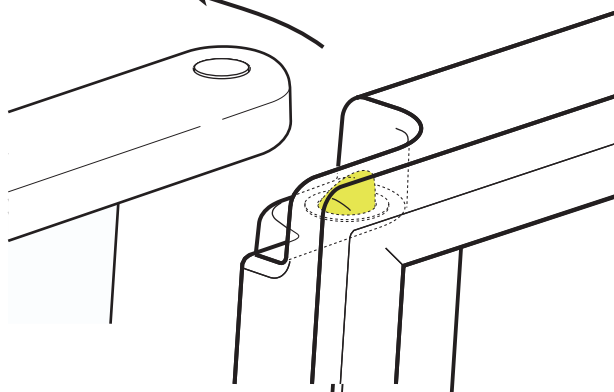

**3**

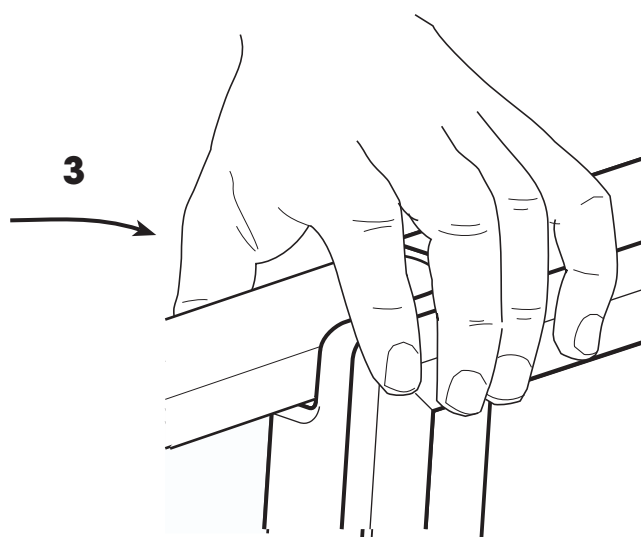

### Function door open/close:

1. Brief activation of the switch on the door handle automatically releases the door (see ill. 1).
2. The door can now be opened\*.
3. Close the door, pushing the handle firmly into the catch (ill. 3).  
**Warning!** You must hear the handle click into place.

\* The bath may be fitted with a battery-operated or 230 V mains-connected safety device. This will prevent the door from opening when the bath is full. The sensor is fitted on the floor near the door. The electronics will only release the door when all the water has run out of the bath. (**Warning!** Must be connected by a suitably qualified and certificated electrician)

5.



1. First fill the tub with water.
2. Check to ensure the door does not leak;  
if it does, re-adjust the door appropriately  
(see page 14, fig. X).
3. After the leakage test, mount the skirting units.

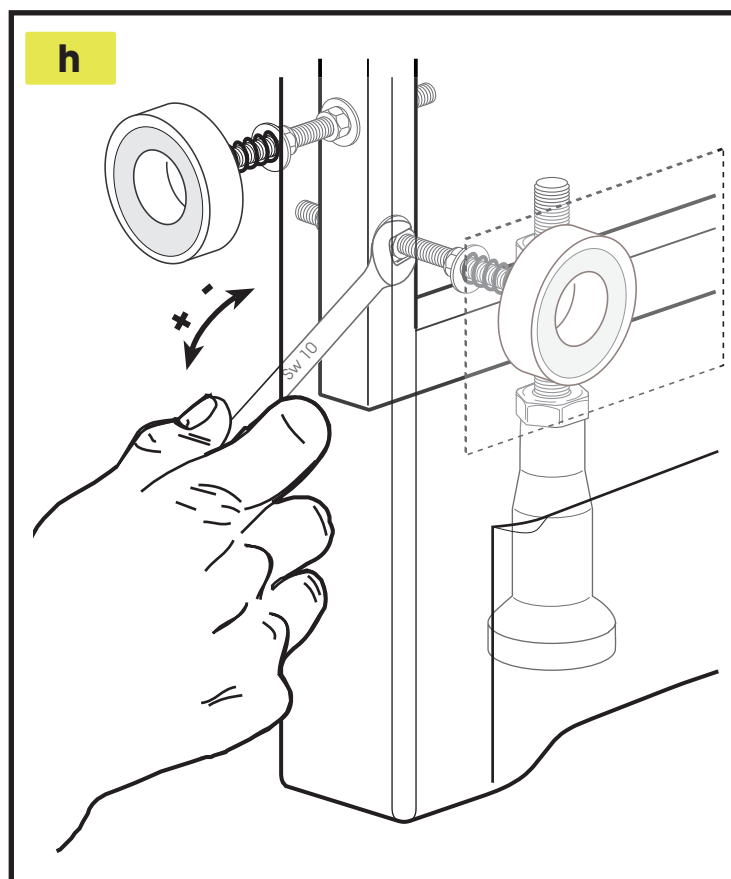
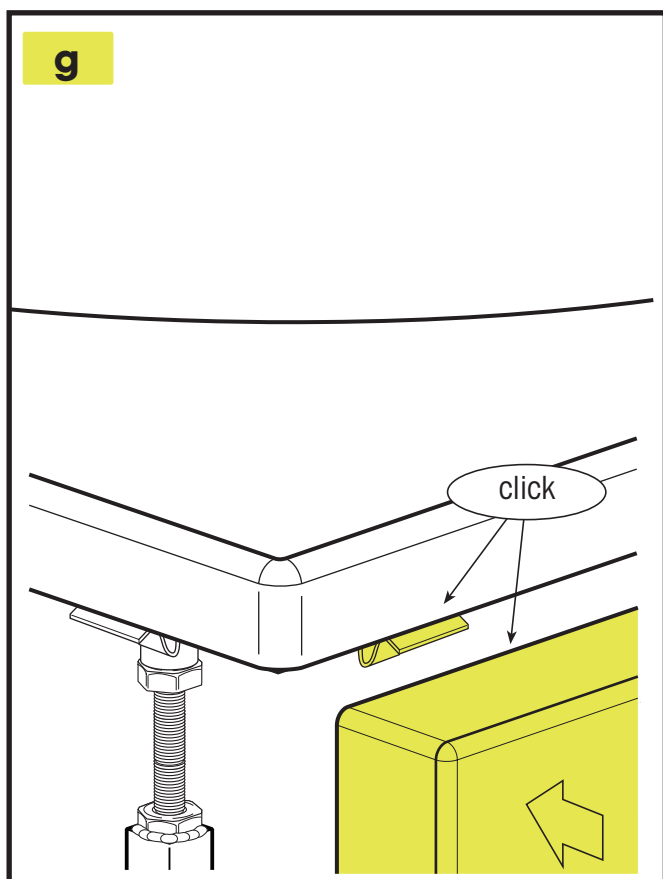
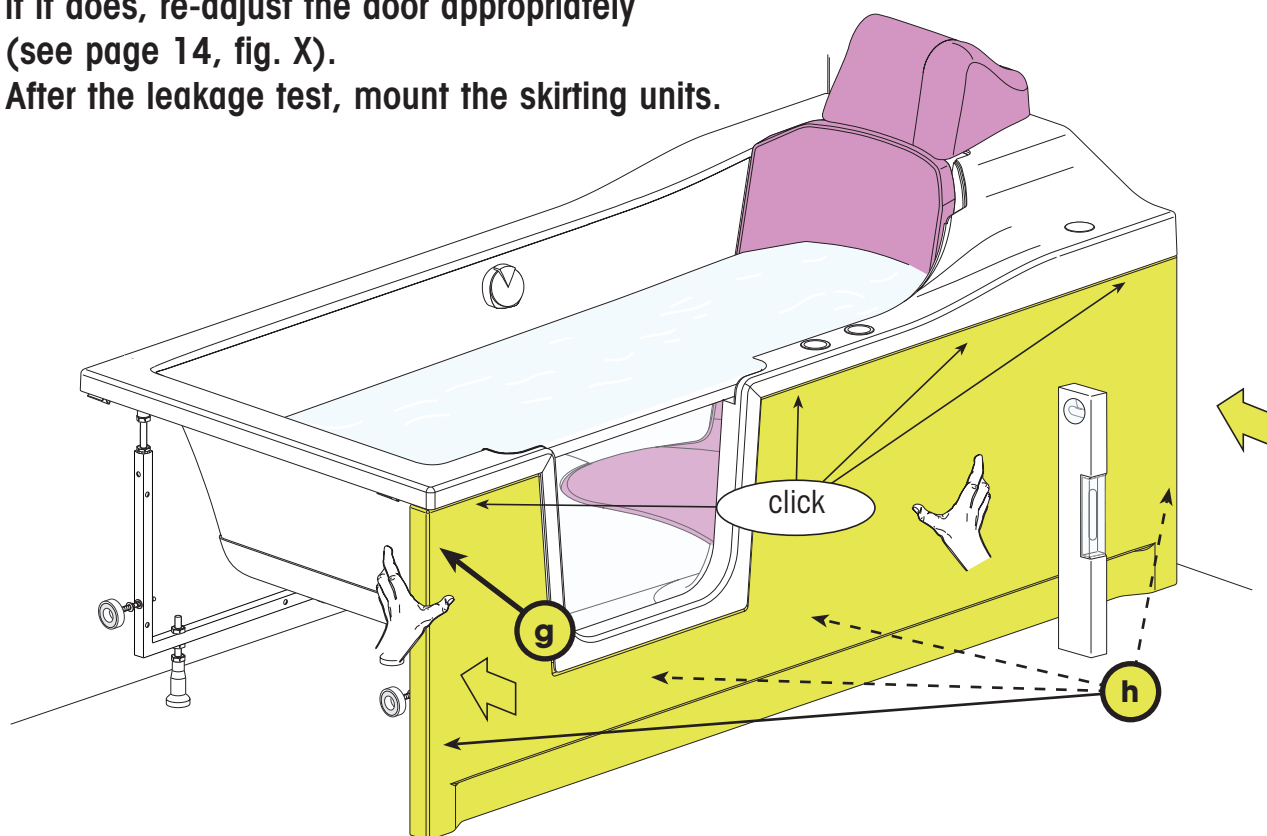

## INSTALLATION WITH APRON

6.

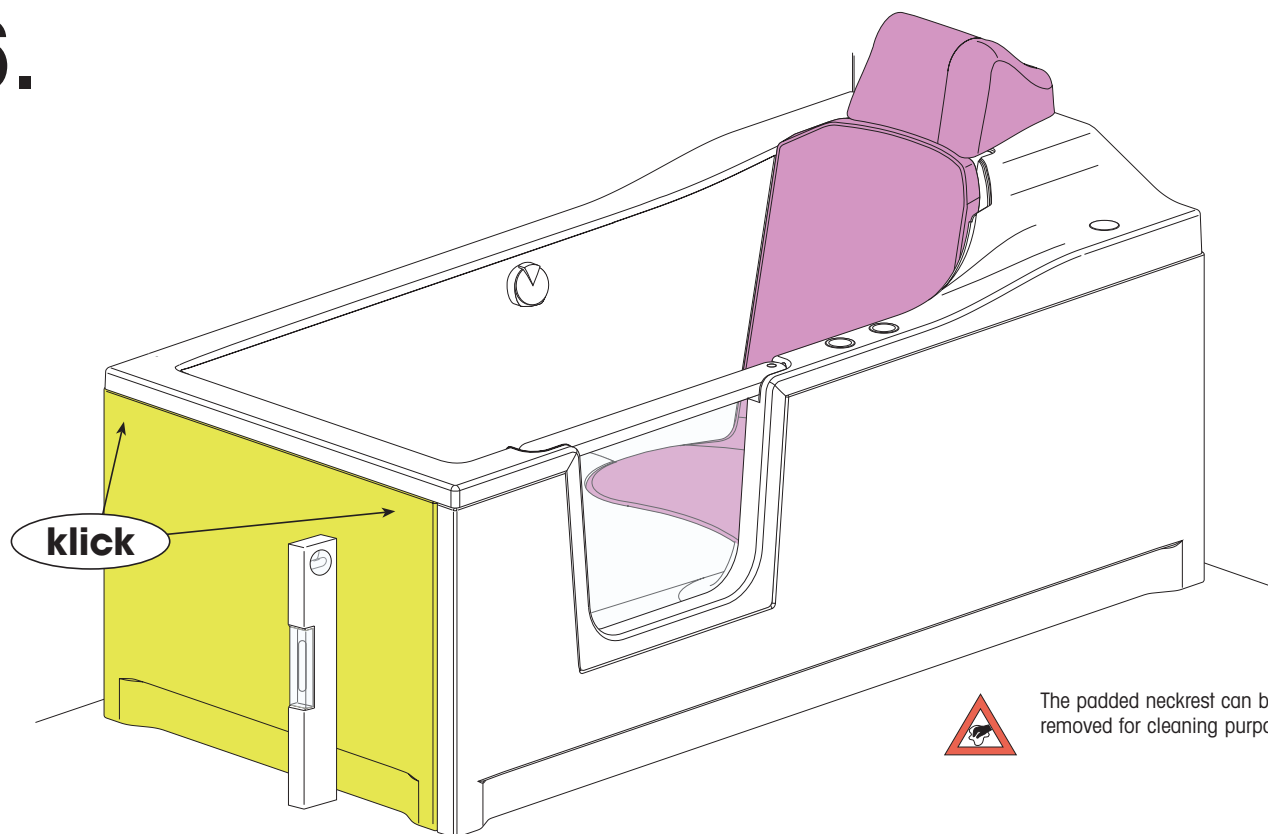

Seal with silicone DIN 18545 when filled.

7.

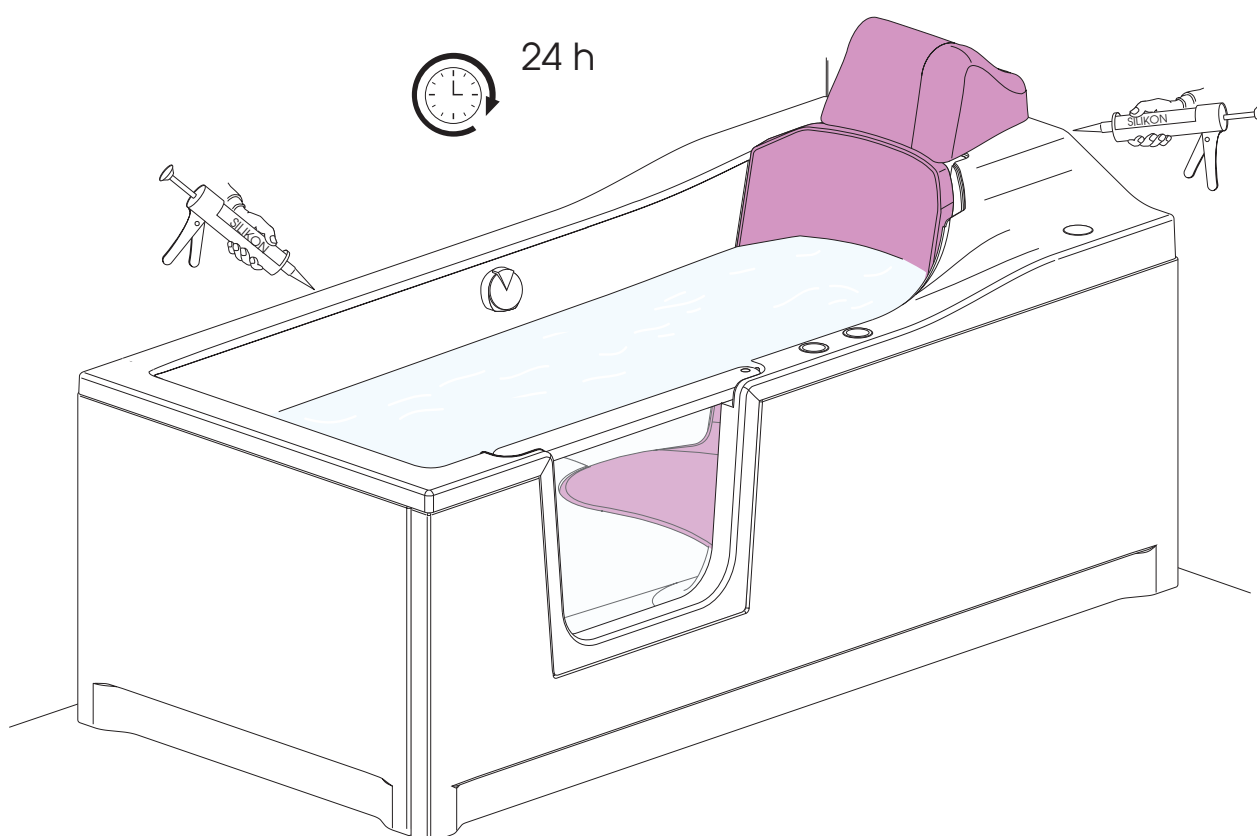

## MAINTENANCE; SEAT REMOVAL / INSTALLATION

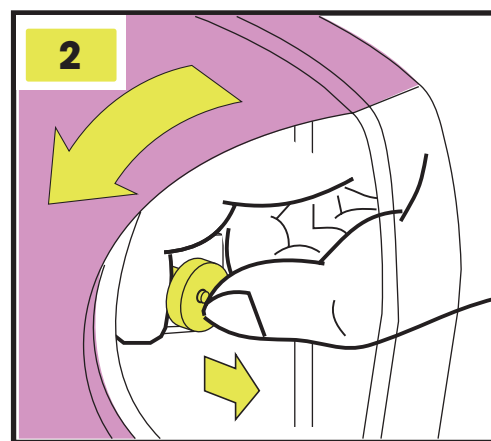
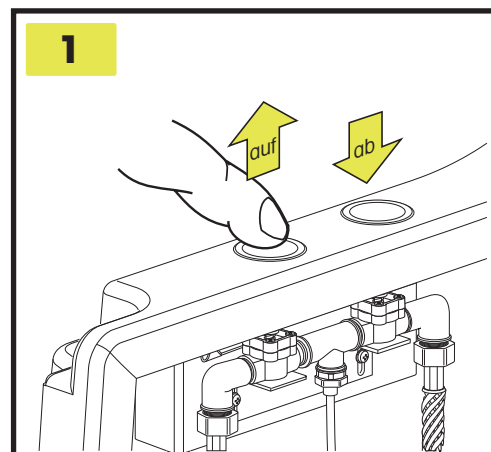
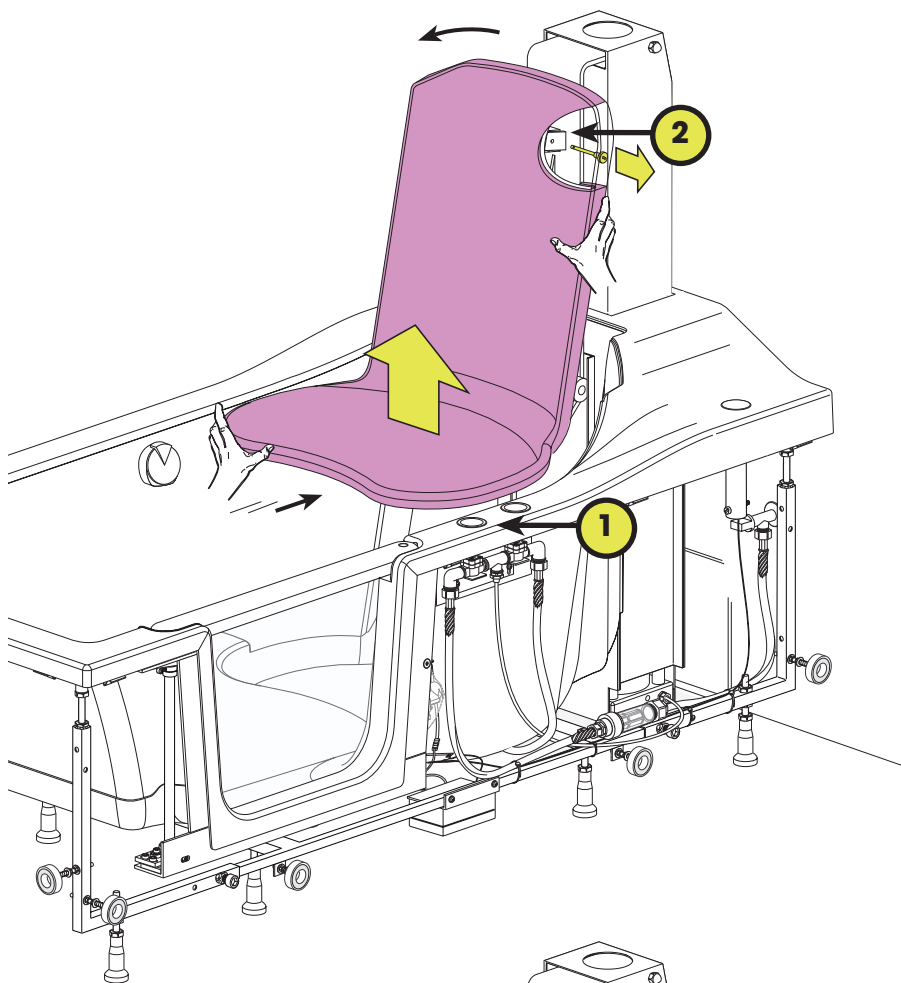

The seat can be removed without any difficulty to facilitate bathtub cleaning.

### Procedure

- Press button to move lift upwards [fig. 1].
- Press locking pin and pull it out together with the bolt [fig. 2].
- Press top of backrest forwards in the direction of the arrow [fig. 2].
- Push seat element backwards a short distance until the entire seat unit can be lifted easily out of the bathtub.
- Installation occurs in the reverse order, whereby care must be taken to ensure that the two guide pins underneath the seating element are positioned correctly.

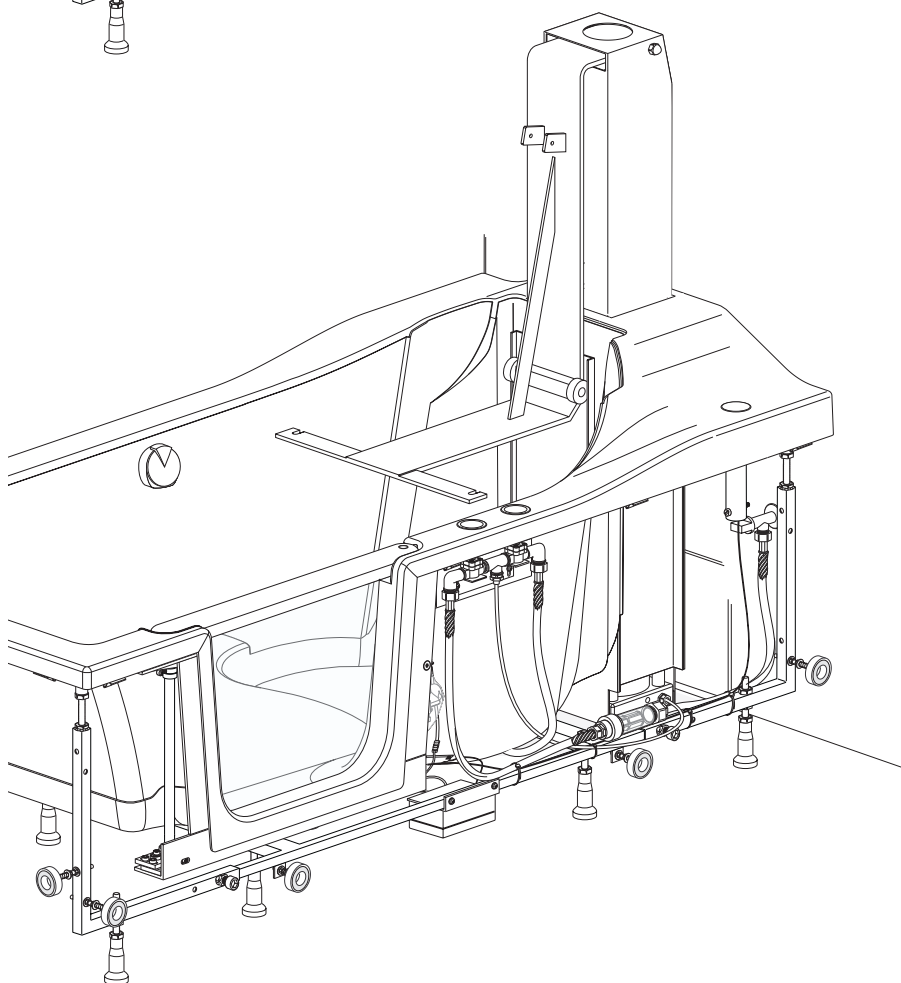

## MAINTENANCE; WASTE WATER FILTER REPLACEMENT

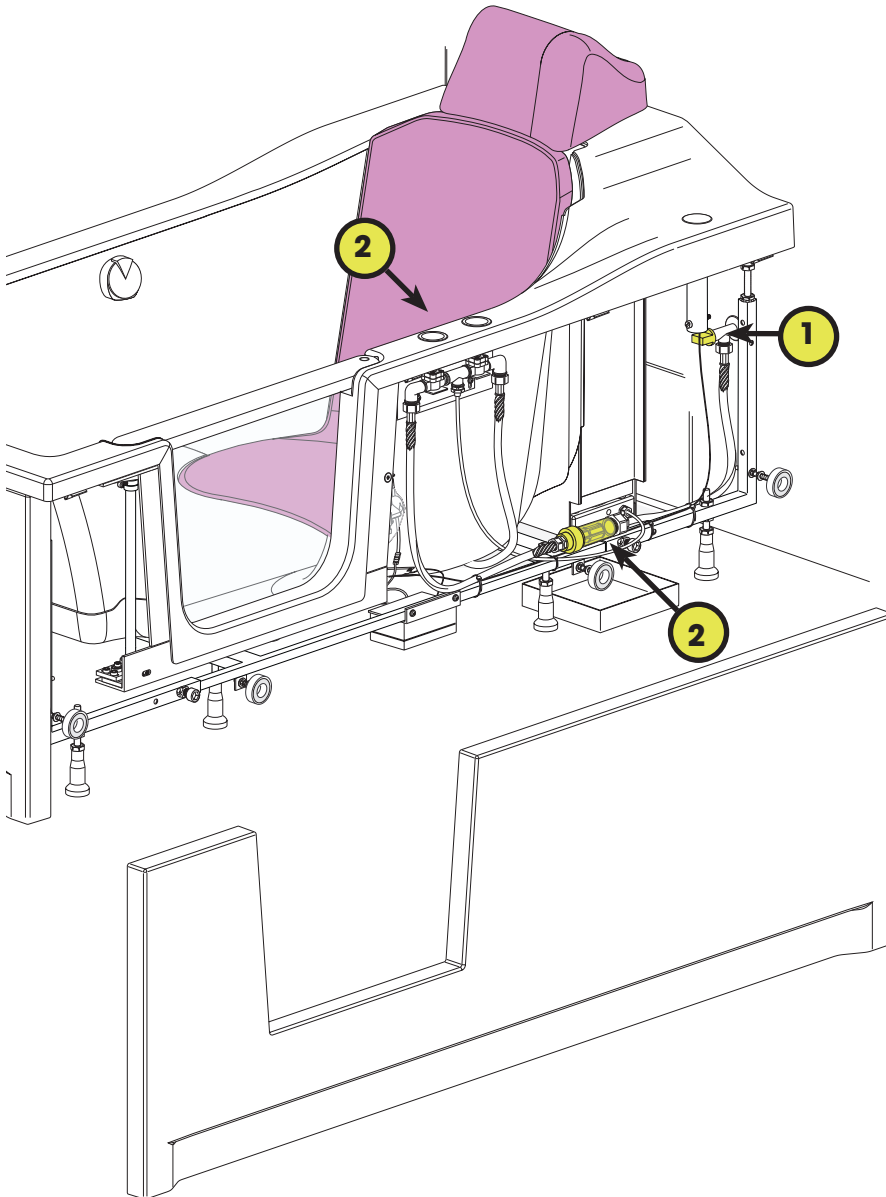

**Warning!** The filter insert must be cleaned or replaced according to DIN 1988-8 for hygienic reasons every 6 months. We recommend replacing the O-ring for the housing every 2 years.

### Procedure

- Remove front apron from the bathtub.
- Put shallow container underneath the filter.
- Close shut-off valve [fig. 1]
- Depressurise system [fig. 2]; to this end, move lift downwards and then press the two buttons for raising and lowering the lift simultaneously to depressurise the system.
- Unscrew water supply (3.1) connection [fig. 3].
- Unscrew filter housing (3.2) by hand.
- Clean the soiled filter insert (3.3) or replace it with a new filter insert.
- Make sure the sealing surfaces and the O-ring (3.4) are clean before screwing the filter housing back in place by hand as far as it will go.
- Screw the water supply connection back on.
- Make sure the connections do not leak and function correctly.
- Commissioning; once the installation work has been completed, open the shut-off valve to put the filter into operation (the system bleeds itself following 2 cycles of the raising / lowering process).

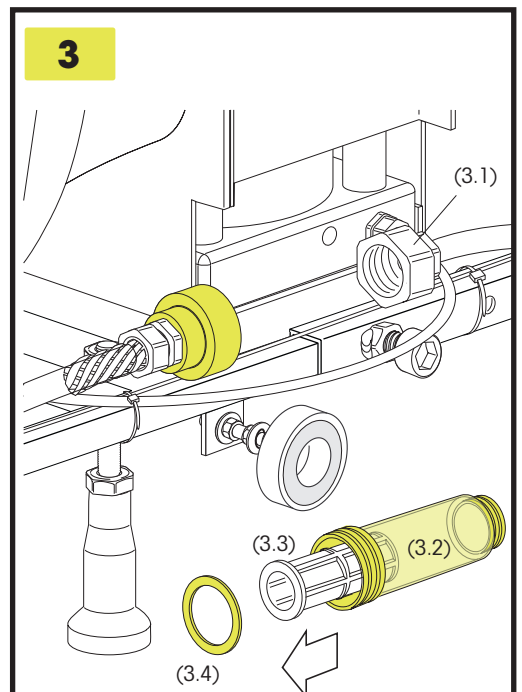
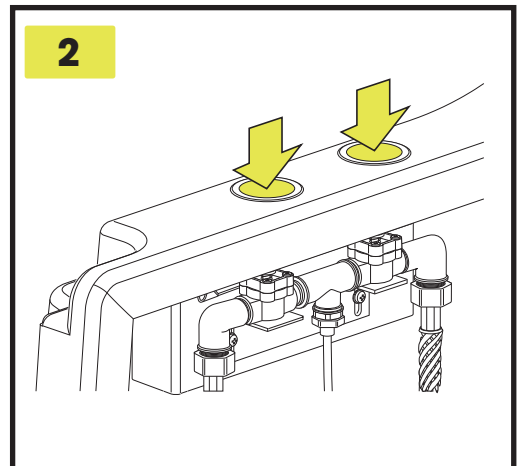
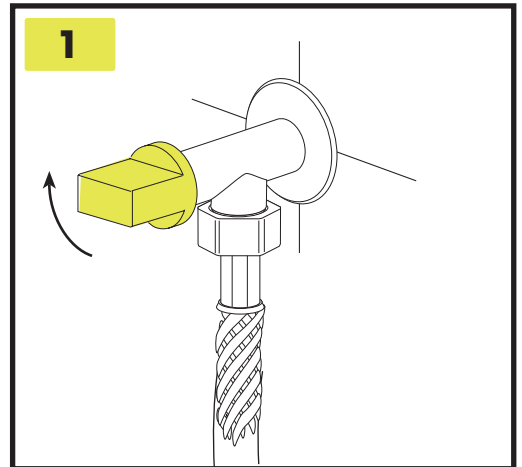

KÄRCHER  
4.730-059  
Water filter: Prevents dirt particles  
in water supply getting into pump

# WHAT TO DO, IF ...

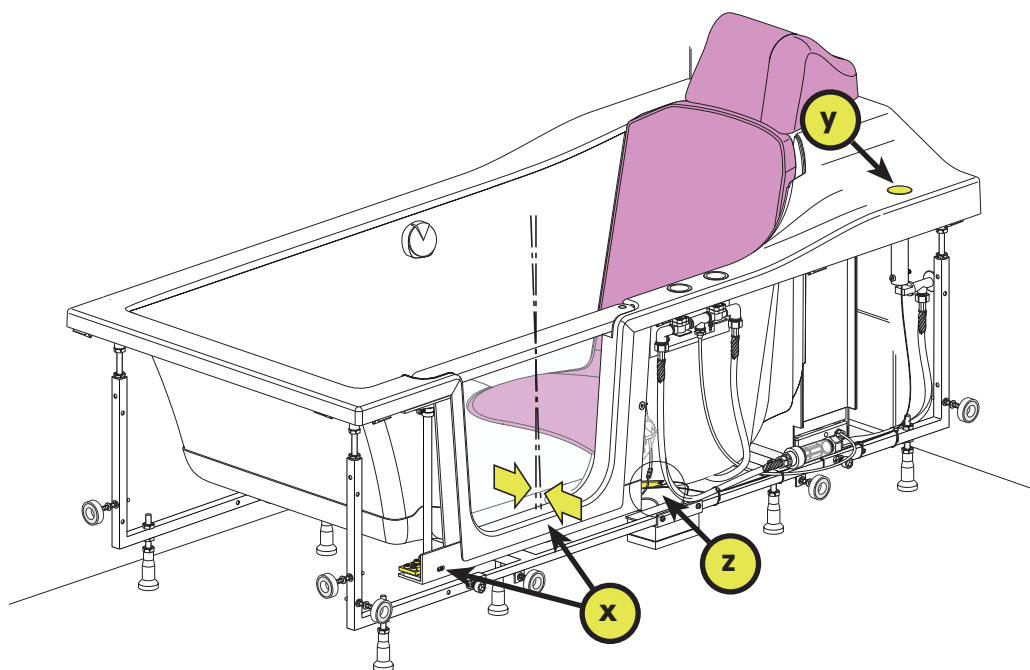

**x**



The pressure between the glass and the rubber door seal can be adjusted slightly using the adjustment screw.

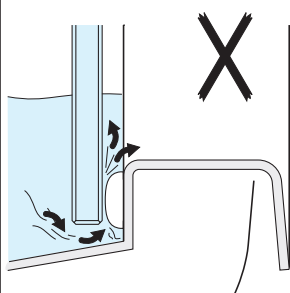
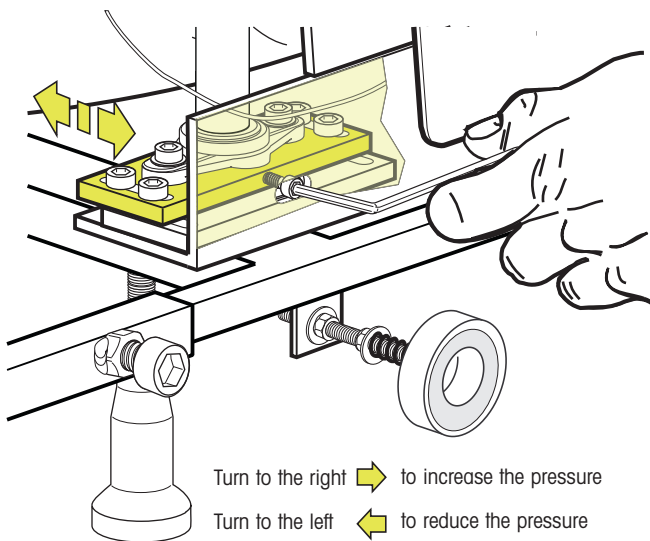

a) Door pane

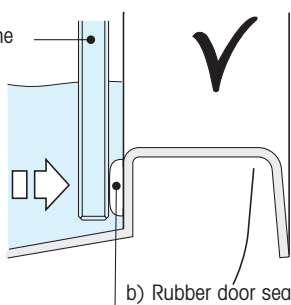

**y**

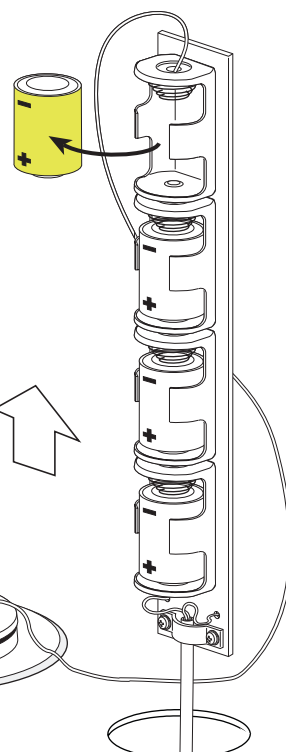
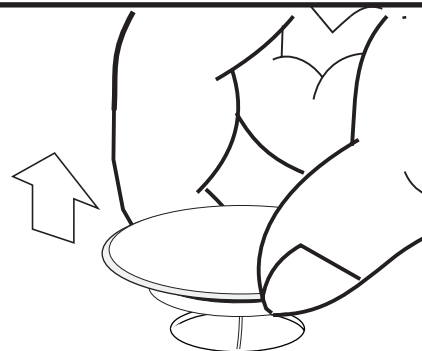

## WHAT TO DO, IF ...

Problem	Possible cause:	Remedy
Unable to open the door	The batteries have expired. The batteries will last for approx. 5000 opening actions.	To replace the batteries (ill. y), lift up the chrome-plated cover. Pull the battery holder out of the opening using the tape. The batteries can now be replaced (make sure they are inserted correctly). Then put the battery holder back in position and click the cover back into place. <b>Warning!</b> Only use batteries type CR2 (quantity 4).
Unable to open the door	There is still some water in the bath	* The bath may be fitted with a battery-operated or 230 V mains-connected safety device. This will prevent the door from opening when the bath is full. The sensor is fitted on the floor near the door. The electronics will only release the door when all the water has run out of the bath. <b>(Warning! Must be connected by a suitably qualified and certificated electrician)</b>
Unable to open the door	Sensor not responding	Check to see whether there is a wet sponge or a towel etc. in the direct vicinity of the sensor area (ill. z). Clear the area.
Door leaking slightly	The pressure between the pane and the rubber door seal is too low.	The pressure between the glass and the rubber door seal can be adjusted slightly using the adjustment screw (ill. x).
Lift operation is disrupted	Soiling and/or differential pressure too high	The filter insert should be replaced.
Lift operation is disrupted	The pressure in the house water supply system is too high	The running speed of the lift can be adjusted slightly with the aid of the shut-off valve.
Seat jolts in lift operation mode	Air in the supply system	Bleed the supply system by moving the seat up and down several times. Have the house water supply system checked.



SANIKU



B&S GmbH, Fichtenstrasse 18, D-56584 Anhausen, Germany

07

**EN 14516:2006**

Bath made of sanitary-grade acrylic.

B&S GmbH  
Fichtenstrasse 18  
D-56584 Anhausen  
Germany

Tel.: 0 26 39 / 96 16-0  
Fax: 0 26 39 / 96 16-22  
Email: [info@saniku.de](mailto:info@saniku.de)  
Internet: [www.saniku.de](http://www.saniku.de)

A member of the  
Dusar group of companies